

LAN ASSOCIATES
engineering • planning • architecture • surveying
445 GODWIN AVENUE, MIDLAND PARK, N.J. 07432 (201) 447-6400

MATTHEW M. WEBB, PLS
PROFESSIONAL LAND SURVEYOR
NJ LICENSE NO. 24GS04330200

REVISIONS

DRAWN BY: MMW
CHECKED BY: MMW
SCALE: NTS
DATE: 4/8/11

INTERIOR DIMENSION SKETCH OF
AREAS LOCATED AT
206 PEGASUS AVENUE
BOROUGH OF NORTHVALE
BERGEN COUNTY, NEW JERSEY

FLD BK: PG:
Job No. 2.8163.0
SHT. 1 of 2

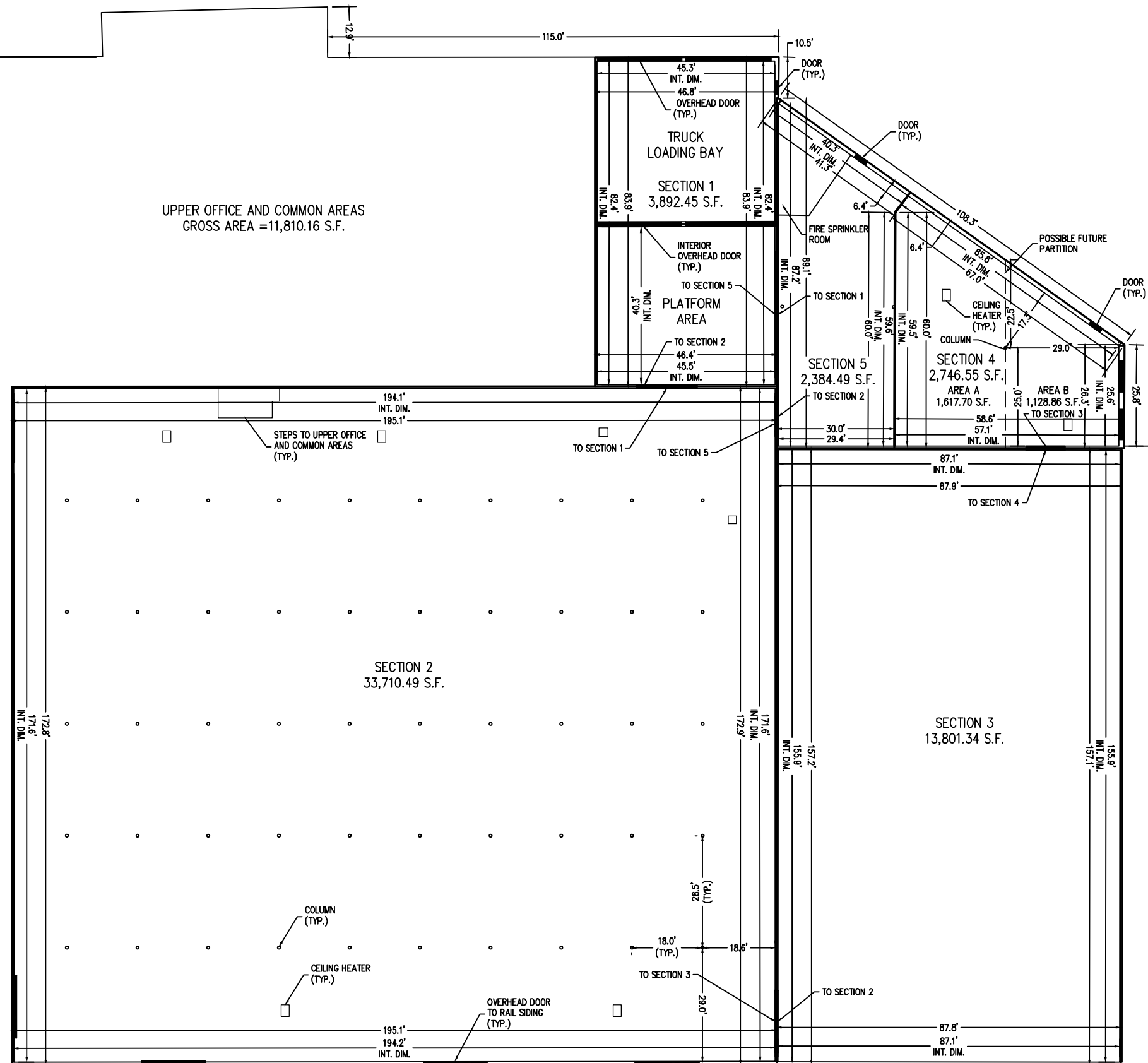

NOTES:
 1. AREAS CALCULATED TO CENTERLINE OF INTERIOR WALLS AND EXTERIOR FACE OF EXTERIOR WALLS.
 2. INTERIOR DIMENSIONS AND DIMENSIONS RELATING TO THE CALCULATION OF SECTION AREA SHOWN HEREON.

NORTHVALE BUSINESS CENTER
 206 PEGASUS AVENUE, NORTHVALE, NJ
 OWNER: NORTHVALE HOLDING, LLC

LAN ASSOCIATES

engineering • planning • architecture • surveying
 445 GODWIN AVENUE, MIDLAND PARK, N.J. 07432 (201) 447-6400

Certificate of Authorization
 Eng'r. Nos. GA276878
 Arch. Nos. AC124

MATTHEW M. WEBB, PLS
 PROFESSIONAL LAND SURVEYOR
 NJ LICENSE NO. 24GS04330200

REVISIONS

DRAWN BY: MMW
 CHECKED BY: MMW
 SCALE: NTS
 DATE: 4/8/11

INTERIOR DIMENSION SKETCH OF
 AREAS LOCATED AT
 206 PEGASUS AVENUE
 BOROUGH OF NORTHVALE
 BERGEN COUNTY, NEW JERSEY

FLD BK: PG:
 Job No. 2.8163.0
 SHT. 2 of 2